

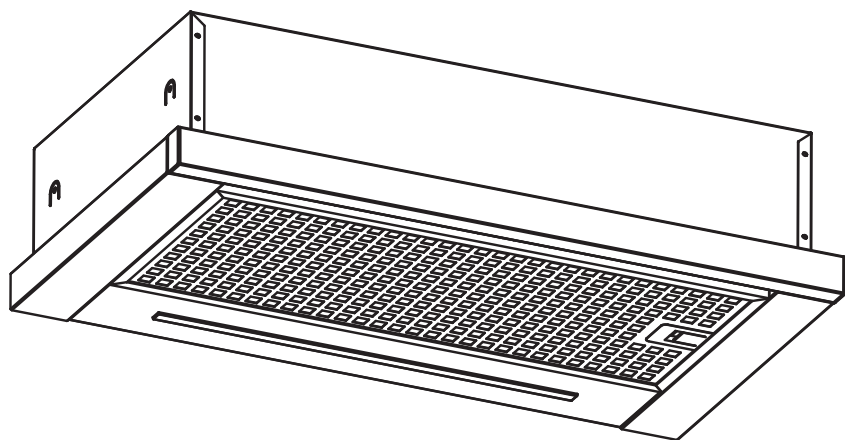

cata 
new tech



ES MANUAL DE INSTRUCCIONES

EN INSTRUCTIONS FOR USE

FR MANUEL D'UTILISATION

PT MANUAL DE INSTRUÇÕES

DE GEBRAUCHSANWEISUNG

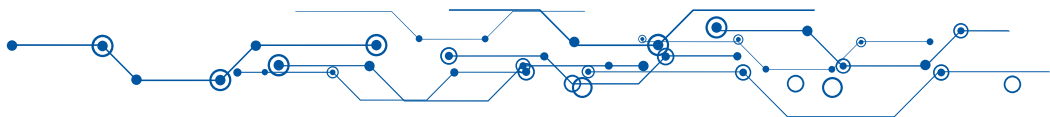



ES IMPORTANTE - Por favor lea atentamente la guía de seguridad antes del uso.

EN IMPORTANT - Please read carefully the separate safety guide before use.

FR IMPORTANT - Lire attentivement le guide de sécurité avant utilisation.

PT IMPORTANTE - Por favor, leia o guia de segurança com cuidado antes de usa.

DE WICHTIG - Bitte lesen Sie die Sicherheitsanleitung vor dem Gebrauch sorgfältig durch.



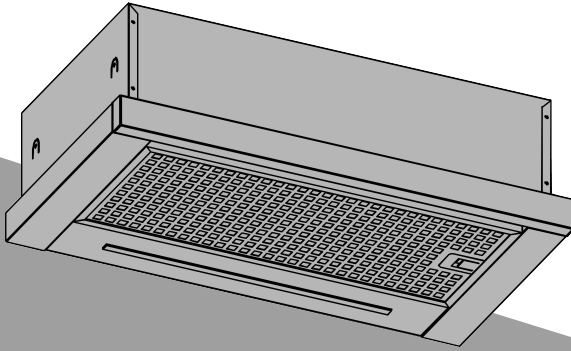
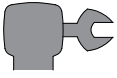

a1 x1



a2 x1



a3 x1

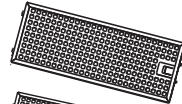

a4 x1

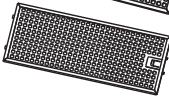

a5 x3

⊕ (4 x 8mm)

a6 x2

⊕ (3.5 x 10mm)

a7 x4

(6 x 40mm)

a8 x4

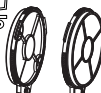
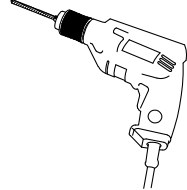
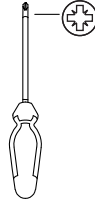
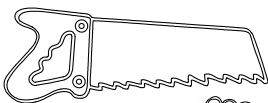

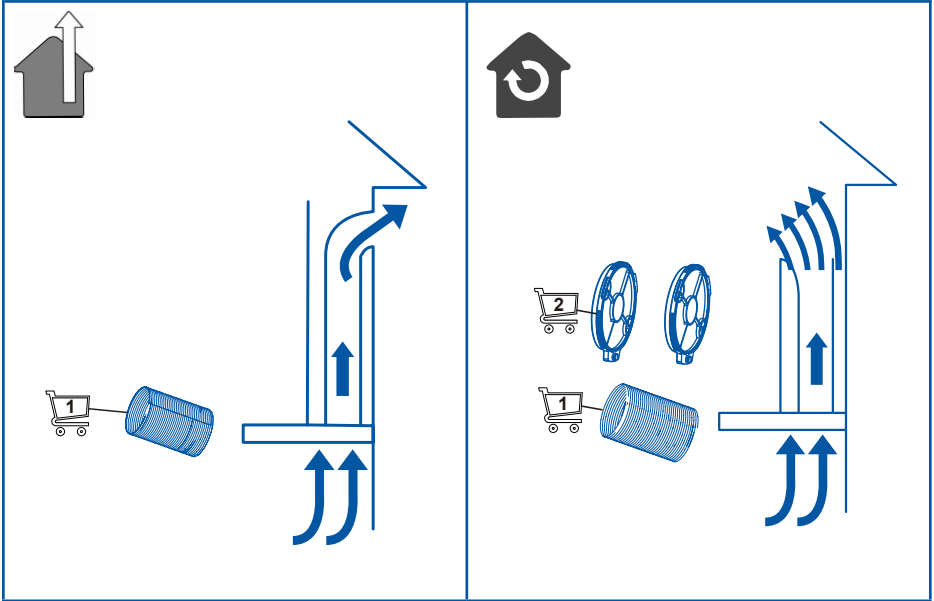

01

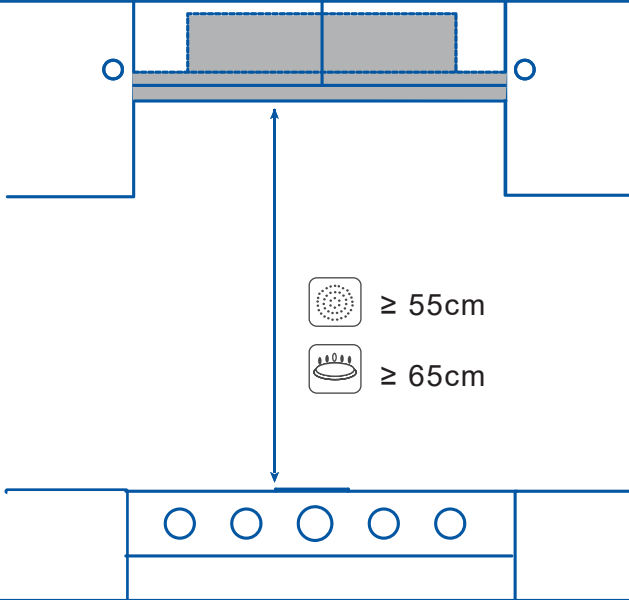

02

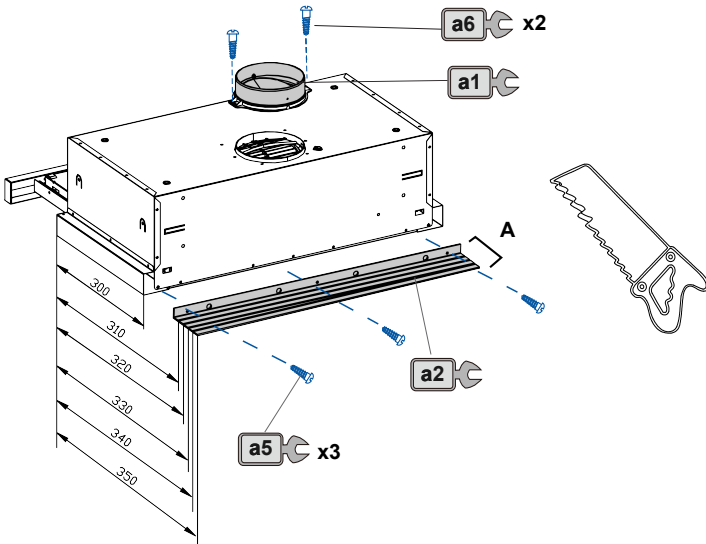

03

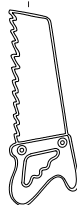
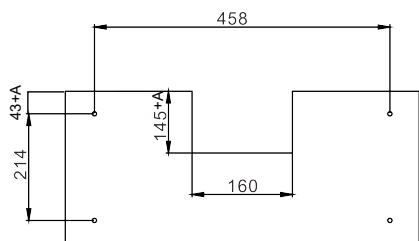
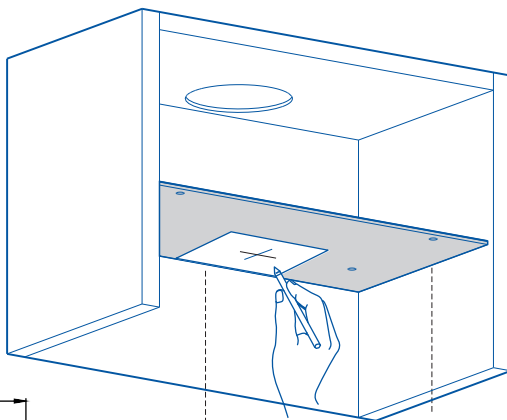

04

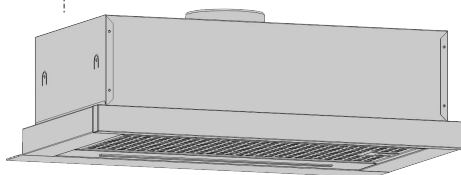
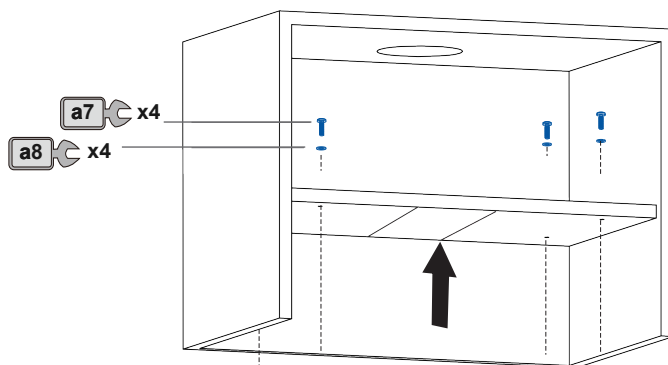

05

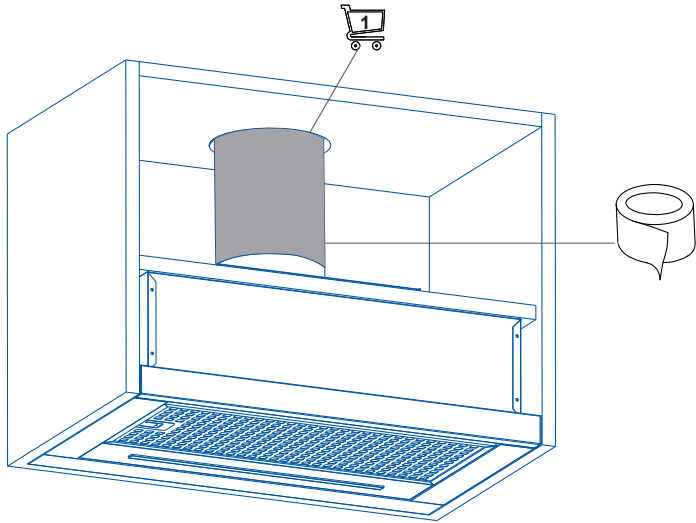

06

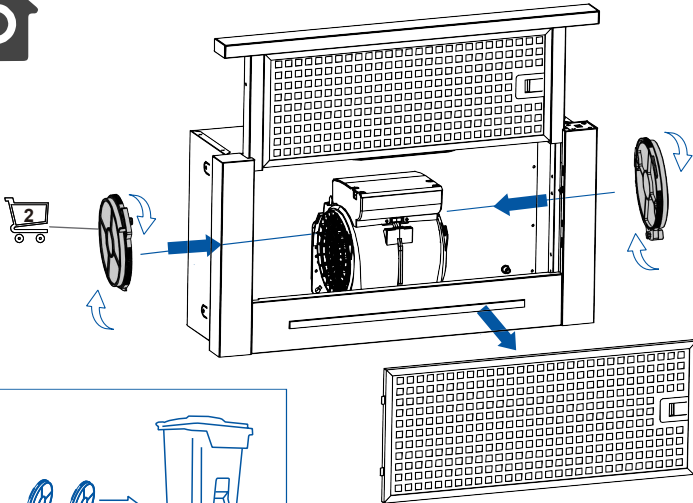

3 MESES
3 MONTHS
3 MOIS
3 MESES
3 MONATE

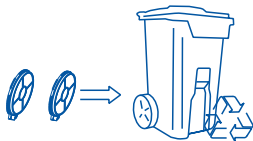



Extienda el panel frontal hasta su máximo recorrido para optimizar su capacidad de extracción. El conmutador de tres posiciones tiene las siguientes funciones:

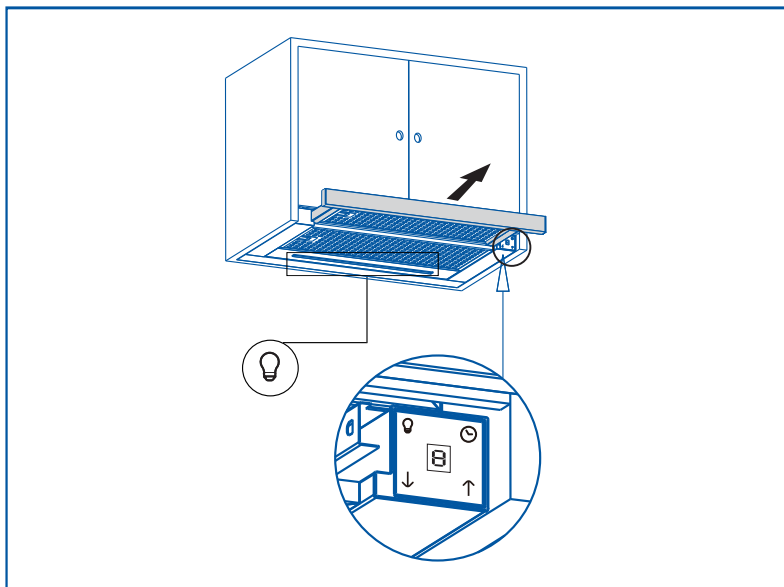



Four-button panel



To obtain the best results from your cooker hood it is recommended that you leave it switched on for up to 15 minutes after you have finished cooking.







	Light On/Off
	Fan On/Off and Speed Reduction
	LED Display
	Boost Function and Speed Increase
	Timer

To Set Up For First Use

Ducted Option  This is the factory default setting if you are extracting air to the outside.

Recirculation Option  This is the option to be used with carbon filters.

To change to this option, press both Speed icons   together and the Timer  will flash red.

Press the Speed Increase  to change to the Recirculation Option  and the Speed Reduction  to revert back to the Ducted Option . Finally, press both Speed icons   together one more time to confirm the change and the Timer  will stop flashing.



NOTE: This operation must be undertaken within two minutes of switching the power on at the mains outlet. To change this setting at a later time, switch off the power at the mains outlet, wait a few seconds, turn on the power and repeat the above.

General Use



Light On/Off

- Use this control to switch the light on independently of the fan motor, it will be lit red in this mode.
- When the fan is in use, and the light is off, the icon  will be lit white in this mode, but will turn red if the light is then switched on.

Fan On/Off and Speed Reduction

- Press this icon once to turn on the fan motor at speed 1. All icons will be lit white and the light icon will be red if already in use.
- If the motor is on speed 1, pressing and holding this icon for two seconds will turn off the fan motor. As above, the light control is independent of this operation.
- If the motor is higher than speed 1, this will reduce the fan speed with each press of the icon.





LED Display

- Press this icon once to turn on the fan motor at full power, and P will flash in the display,
- If the motor is already on speed 1-3, each press of this icon will increase the fan speed accordingly.
- If you press and hold the icon for two seconds, the fan speed will increase to full power and P will flash in the display.
- Shows the extraction mode during set up  or  and the motor speeds from 1-3, and P for Boost. **Boost Function and Speed Increase**



NOTE: Full power or Boost only operates for five minutes maximum to conserve energy and the fan speed will automatically drop to speed level 3 after this time.

Timer

- When the fan motor is on and the Timer  icon is pressed, the icon will be lit red and the current speed in the display will start to flash.
- The chosen speed level will remain in use for five minutes before dropping down to the next lowest speed. This speed will remain in operation for two minutes before dropping down again. This will be repeated every two minutes unless the speed is already at level 1 and then the fan will turn off. If the light is already on, this will also be turned off.
- Pressing the Speed Reduction  or Speed Increase  icon during a current timer program will restart the countdown process again with a five minute cycle.
- If the Timer  icon is pressed again during a current timer program, the cycle will be cancelled, the icon will revert to white and the current fan speed will remain on indefinitely.
- The maximum timer program cycle is 11 minutes: 5 minutes on P and then 2 minutes each on speed 3 down to speed 1.



MANTENIMIENTO DE LA CAMPANA



Atención: corte siempre el suministro eléctrico antes de realizar el mantenimiento de la campana. En caso de avería, contacte a un distribuidor oficial o un agente autorizado.

Limpieza externa: use detergente líquido, no corrosivo y evite el uso de productos de limpieza abrasivos y disolventes.

No utilizar dispositivos de limpieza por alta presión o vapor.



Importante: aumente la frecuencia de limpieza/sustitución de filtros si la campana se usa más de 2 horas diarias. Utilice siempre filtros originales del fabricante.

Filtros de grasa

Para evitar posibles incendios límpielos rigurosamente una vez al mes o cuando el testigo indicador lo advierta. Para ello, desmonte los filtros y lávelos con agua caliente y detergente. No usar abrillantador. Si usa lavavajillas (podría ennegrecer las partes metálicas sin afectar a su capacidad funcional), disponga verticalmente los filtros para evitar que se depositen restos sólidos.

1 MES

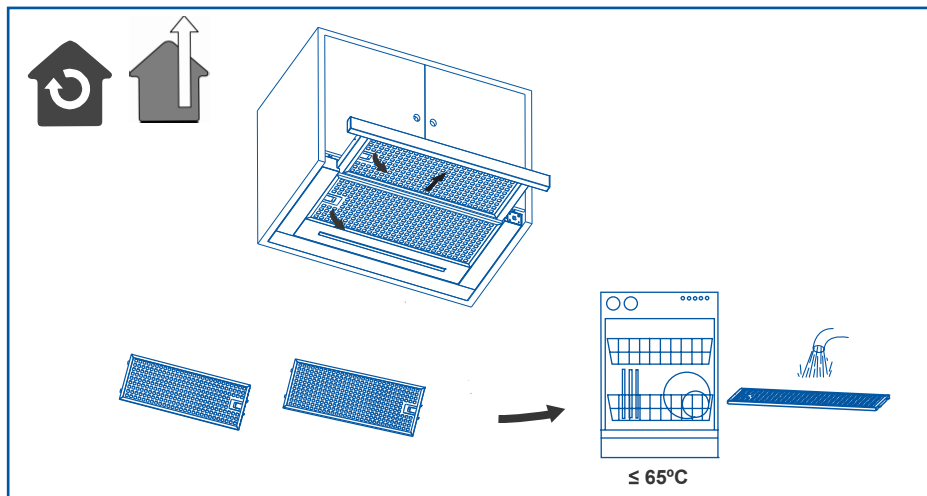



Problema	Posible causa	Solución
Vibración excesiva.	El aparato no está instalado correctamente en los soportes.	Intente quitar el aparato y compruebe que está bien fijado.
	El aspa del ventilador está dañada.	Apague el aparato. La reparación solo debe llevarla a cabo el personal de servicio cualificado.
	El motor del ventilador no está bien fijado.	
La luz está encendida, pero el ventilador no funciona	El aspa del ventilador está atascada.	Apague el aparato. La reparación solo debe llevarla a cabo el personal de servicio cualificado.
	El motor está dañado.	
No funcionan ni la luz ni el motor.	Bombilla fundida.	Póngase en contacto con el servicio de atención al cliente .
	Conexión eléctrica suelta.	Compruebe la fuente de alimentación.
Potencia de succión reducida.	La velocidad puede ser demasiado baja.	Seleccione una velocidad más alta.
	El kit opcional de ventilación podría estar torcido.	(Consulte la sección Cuidado y mantenimiento).
	La ventilación superior puede estar obstruida.	Extraiga cualquier obstrucción.
	El kit opcional de ventilación podría estar torcido.	Asegúrese de que el kit de ventilación está equipado de acuerdo con las instrucciones del fabricante.
	La instalación puede que no cumpla con las instrucciones del fabricante.	El tubo de ventilación debe tener el diámetro correcto a lo largo sin reducciones ni restricción. (Consulte la sección de instalación).
Funciona con normalidad, pero los olores persisten.	Filtro de carbono no está instalado en modo de recirculación o está lleno de grasa.	Coloque el filtro de carbono o sustitúyalo (Consulte la sección Cuidado y mantenimiento).
La campana no funciona	Revisar que la campana está conectada a corriente. Revisar que no han saltado los fusibles o automáticos.	
La campana sigue sin funcionar	Si, después de haber comprobado los puntos mencionados anteriormente, su problema aún persiste, póngase en contacto con el servicio técnico o con su distribuidor.	



USE





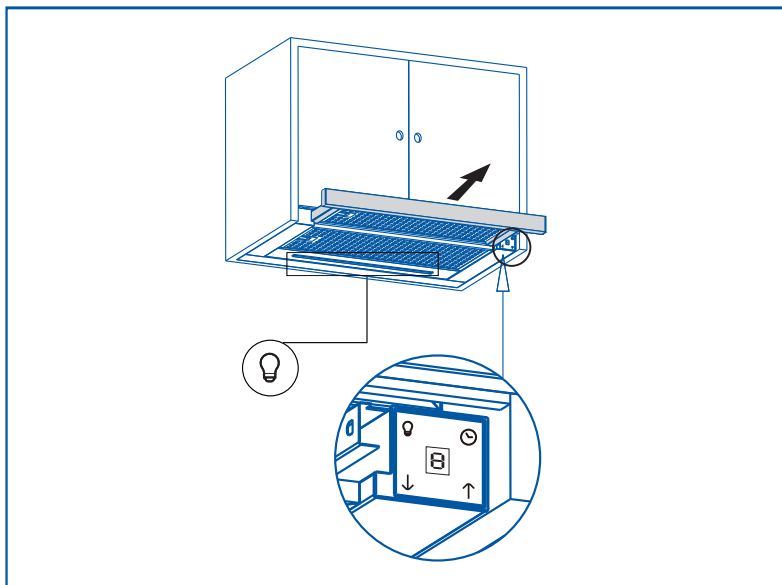





The front panel has to be pulled its maximum extension so as to optimise the extraction capa-city.

The three setting switch has the following functions:



Four-button panel

To obtain the best results from your cooker hood it is recommended that you leave it switched on for up to 15 minutes after you have finished cooking.

	     
	Light On/Off
	Fan On/Off and Speed Reduction
	LED Display
	Boost Function and Speed Increase
	Timer

To Set Up For First Use

Ducted Option \square This is the factory default setting if you are extracting air to the outside.

Recirculation Option \equiv This is the option to be used with carbon filters.

To change to this option, press both Speed icons $\downarrow \uparrow$ together and the Timer \odot will flash red.

Press the Speed Increase \uparrow to change to the Recirculation Option \equiv and the Speed Reduction \downarrow to revert back to the Ducted Option \square . Finally, press both Speed icons $\downarrow \uparrow$ together one more time to confirm the change and the Timer \odot will stop flashing.



NOTE: This operation must be undertaken within two minutes of switching the power on at the mains outlet. To change this setting at a later time, switch off the power at the mains outlet, wait a few seconds, turn on the power and repeat the above.

General Use

Light On/Off

- Use this control to switch the light on independently of the fan motor, it will be lit red in this mode.
- When the fan is in use, and the light is off, the icon will be lit white in this mode, but will turn red if the light is then switched on.

Fan On/Off and Speed Reduction

- Press this icon once to turn on the fan motor at speed 1. All icons will be lit white and the light icon will be red if already in use.
- If the motor is on speed 1, pressing and holding this icon for two seconds will turn off the fan motor. As above, the light control is independent of this operation.
- If the motor is higher than speed 1, this will reduce the fan speed with each press of the icon.

LED Display

- Shows the extraction mode during set up \square or \equiv and the motor speeds from 1-5, and P for





Boost. Boost Function and Speed Increase

- Press this icon once to turn on the fan motor at full power, and P will flash in the display,
- If the motor is already on speed 1-5, each press of this icon will increase the fan speed accordingly.
- If you press and hold the icon for two seconds, the fan speed will increase to full power and P will flash in the display.



NOTE: Full power or Boost only operates for five minutes maximum to conserve energy and the fan speed will automatically drop to speed level 3 after this time.

Timer

- When the fan motor is on and the Timer  icon is pressed, the icon will be lit red and the current speed in the display will start to flash.
- The chosen speed level will remain in use for five minutes before dropping down to the next lowest speed. This speed will remain in operation for two minutes before dropping down again. This will be repeated every two minutes unless the speed is already at level 1 and then the fan will turn off. If the light is already on, this will also be turned off.
- Pressing the Speed Reduction  or Speed Increase  icon during a current timer program will restart the countdown process again with a five minute cycle.
- If the Timer  icon is pressed again during a current timer program, the cycle will be cancelled, the icon will revert to white and the current fan speed will remain on indefinitely.
- The maximum timer program cycle is 15 minutes: 5 minutes on P and then 2 minutes each on speed 3 down to speed 1.



CARE & MAINTENANCE



Warning: always switch off the electricity supply before carrying out maintenance work on the hood. In the event of a fault, contact an official distributor or authorised dealer.

Cleaning the outside: use liquid, non-corrosive detergent and avoid using abrasive cleaning products and solvents. Do not use high-pressure or steam cleaning devices.



Important: increase the filter cleaning/replacement frequency if the hood is used for more than 2 hours a day. Always use genuine filters from the manufacturer.

Grease cleaning

To avoid fires, clean thoroughly once a month or whenever the display pilot light indicates as such. To do so, remove the filters and wash with hot water and detergent. If using a dishwasher (metal parts may turn black without this affecting their functional capacity), load the filters vertically to avoid solid residue from being deposited.

1 MONTH

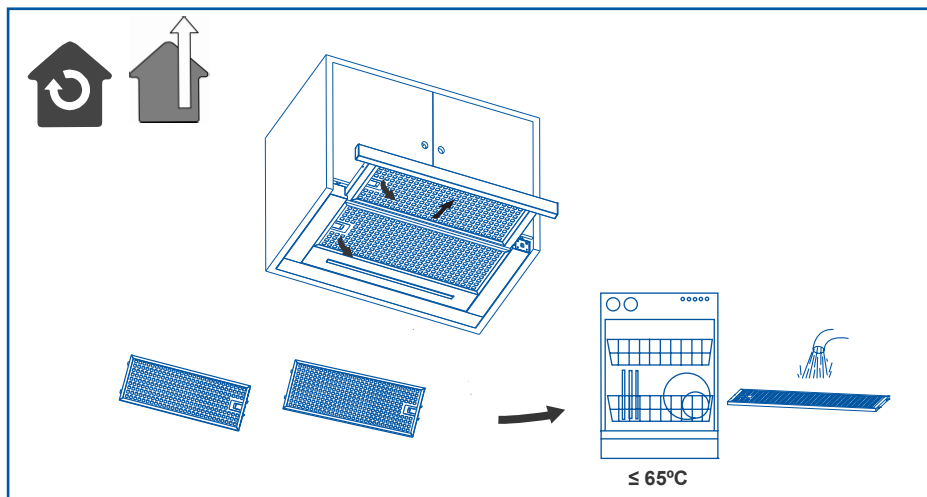



Problem	Possible cause	Solution
Excessive vibration.	The appliance is not installed properly on the brackets.	Take down the appliance and check it is properly fixed.
	The fan blade is damaged.	Switch off the appliance. Repair to be carried out by qualified service personnel only.
	The fan motor is not fixed tightly.	
The light is on, but the fan does not work.	The fan blade is jammed.	Switch off the appliance. Repair to be carried out by qualified service personnel only.
	The motor is damaged.	
Both the light and motor do not work.	Light bulb blown.	Contact Customer Services on.
	Power connection loose.	Check power supply.
Suction performance reduced.	Speed may be too low.	Select a higher speed.
	Aluminium filters are dirty.	Clean the aluminium filters. (See Care and maintenance section).
	Top vent might be obstructed.	Clear any obstruction.
	Optional vent kit might be twisted.	Ensure that the vent kit is fitted according to the manufacturer's instructions.
	The installation may not comply with the manufacturers instructions.	The vent hose should be correct diameter throughout with no reductions or restriction.(See installation section).
Works normally but cooking smells linger.	Carbon filter is not fitted in recirculation mode or is full of grease.	Fit carbon filter or replace the carbon filter (See Care and maintenance section).
The hood does not work	Check that the hood is connected to power. Check that the fuses or automatic have not jumped.	
The hood still does not work	If, after having checked the points mentioned above, your problem has not yet been solved, contact the technical service or your distributor.	



Tirer « le panneau frontal » jusqu'au bout afin d'optimiser sa capacité d'extraction.
Le commutateur de trois positions a les fonctions suivantes:

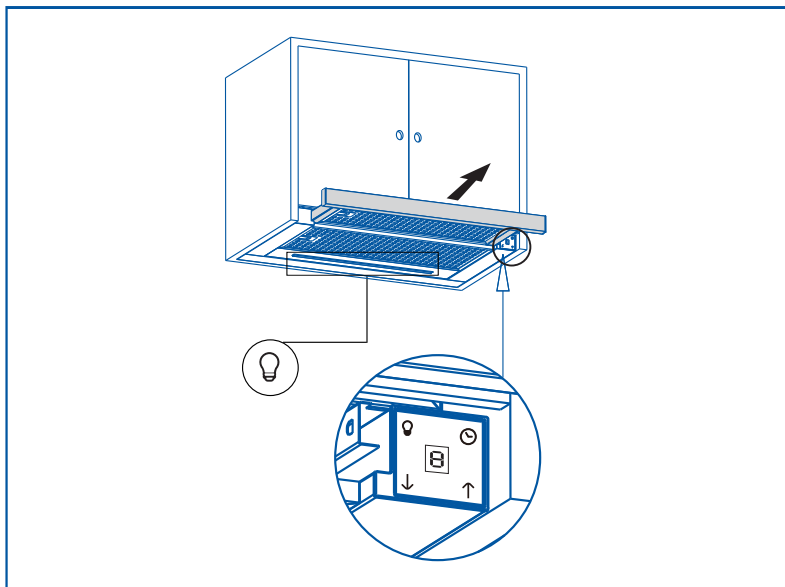

Four-button panel

To obtain the best results from your cooker hood it is recommended that you leave it switched on for up to 15 minutes after you have finished cooking.

	Light On/Off
	Fan On/Off and Speed Reduction
	LED Display
	Boost Function and Speed Increase
	Timer

To Set Up For First Use

Ducted Option \square This is the factory default setting if you are extracting air to the outside.

Recirculation Option \equiv This is the option to be used with carbon filters.

To change to this option, press both Speed icons $\downarrow \uparrow$ together and the Timer \odot will flash red.

Press the Speed Increase \uparrow to change to the Recirculation Option \equiv and the Speed Reduction \downarrow to revert back to the Ducted Option \square . Finally, press both Speed icons $\downarrow \uparrow$ together one more time to confirm the change and the Timer \odot will stop flashing.



NOTE: This operation must be undertaken within two minutes of switching the power on at the mains outlet. To change this setting at a later time, switch off the power at the mains outlet, wait a few seconds, turn on the power and repeat the above.

General Use

Light On/Off

- Use this control to switch the light on independently of the fan motor, it will be lit red in this mode.
- When the fan is in use, and the light is off, the icon will be lit white in this mode, but will turn red if the light is then switched on.

Fan On/Off and Speed Reduction

- Press this icon once to turn on the fan motor at speed 1. All icons will be lit white and the light icon will be red if already in use.
- If the motor is on speed 1, pressing and holding this icon for two seconds will turn off the fan motor. As above, the light control is independent of this operation.
- If the motor is higher than speed 1, this will reduce the fan speed with each press of the icon.

LED Display

- Shows the extraction mode during set up \square or \equiv and the motor speeds from 1-5, and P for

Boost. Boost Function and Speed Increase

- Press this icon once to turn on the fan motor at full power, and P will flash in the display,
- If the motor is already on speed 1-5, each press of this icon will increase the fan speed accordingly.
- If you press and hold the icon for two seconds, the fan speed will increase to full power and P will flash in the display.



NOTE: Full power or Boost only operates for five minutes maximum to conserve energy and the fan speed will automatically drop to speed level 3 after this time.

Timer

- When the fan motor is on and the Timer ⌚ icon is pressed, the icon will be lit red and the current speed in the display will start to flash.
- The chosen speed level will remain in use for five minutes before dropping down to the next lowest speed. This speed will remain in operation for two minutes before dropping down again. This will be repeated every two minutes unless the speed is already at level 1 and then the fan will turn off. If the light is already on, this will also be turned off.
- Pressing the Speed Reduction ↓ or Speed Increase ↑ icon during a current timer program will restart the countdown process again with a five minute cycle.
- If the Timer ⌚ icon is pressed again during a current timer program, the cycle will be cancelled, the icon will revert to white and the current fan speed will remain on indefinitely.
- The maximum timer program cycle is 15 minutes: 5 minutes on P and then 2 minutes each on speed 3 down to speed 1.



ENTRETIEN ET MAINTENANCE



Attention: coupez toujours l'alimentation électrique avant d'intervenir sur la hotte. En cas de défaut, contactez un distributeur officiel ou un agent agréé.

Nettoyage externe : utilisez du détergent liquide, non corrosif et évitez l'utilisation de produits de nettoyage abrasifs et de dissolvants. N'utilisez pas de dispositifs de nettoyage à haute pression ou à vapeur.



Important: Augmentez la fréquence de nettoyage / remplacement des filtres si la hotte est utilisée plus de 2 heures par jour. Utilisez toujours des filtres d'origine du fabricant.

Filtres à graisse

Il y a risque d'incendie si le nettoyage n'est pas effectué conformément aux instructions. Pour cela, démontez les filtres et lavez-les à l'eau chaude et avec du détergent neutre.

Ne pas utiliser de liquide de rinçage. Si vous utilisez un lave-vaisselle (les pièces métalliques pourraient noircir sans que leur bon fonctionnement ne soit affecté), disposez les filtres à la verticale afin d'éviter le dépôt de résidus solides.

1 MOIS

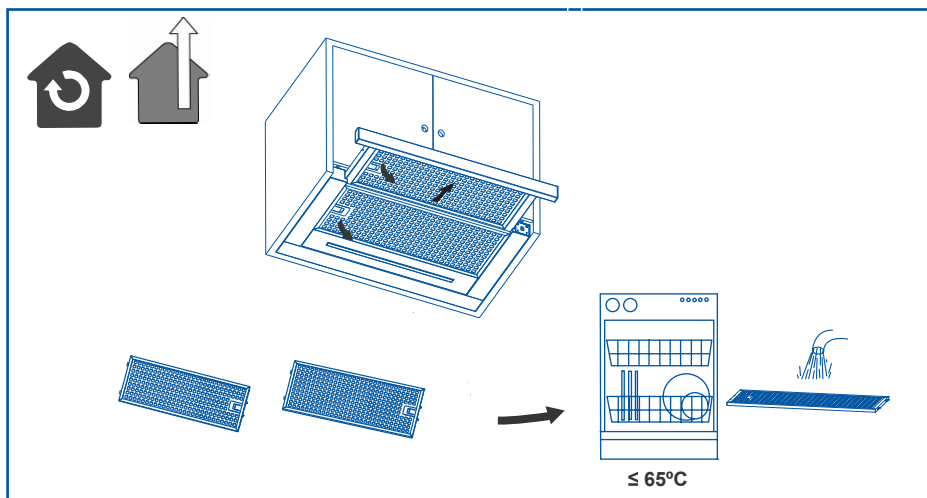



Problème	Cause possible	Solution
Vibration excessive.	L'appareil n'est pas installé correctement sur les supports.	Déposer l'appareil et vérifier qu'il est correctement fixé.
	La pale du ventilateur est endommagée.	Éteindre l'appareil. La réparation doit être effectuée uniquement par un personnel qualifié.
	Le moteur du ventilateur n'est pas fermement fixé.	
Le voyant est allumé, mais le ventilateur ne fonctionne pas.	La pale du ventilateur est bloquée.	
	Le moteur est endommagé.	
Le voyant et le moteur ne fonctionnent pas.	L'ampoule est cassée.	Contacter le service client .
	Connecteur électrique lâche.	Vérifier l'alimentation secteur.
Mauvaise performance d'aspiration.	La vitesse peut être trop lente.	Sélectionner une vitesse supérieure.
	Les filtres en aluminium sont sales.	Nettoyer les filtres en aluminium. (Voir la section Entretien).
	L'évacuation du dessus est peut être obstruée.	Dégager toute obstruction.
	Le kit d'évacuation en option est peut être déformé.	S'assurer que le kit d'évacuation est fixé conformément aux instructions du fabricant.
	L'installation doit être conforme aux instructions du fabricant.	Il convient que le tuyau d'aération soit d'un diamètre correct et uniforme sans réduction ou restriction. (Voir la section Installation).
Le fonctionnement est normal mais des odeurs de cuisson subsistent.	Le filtre à charbon n'est pas équipé d'un mode de recyclage ou est rempli de graisse.	Placer un filtre à charbon ou remplacer le filtre à charbon (Voir la section Entretien).
La hotte ne fonctionne pas	Vérifiez que la hotte est connectée à l'alimentation. Vérifiez que les fusibles ou l'automatique n'ont pas sauté.	
La hotte ne fonctionne toujours pas	Si, après avoir vérifié les points mentionnés ci-dessus, votre problème n'a pas encore été résolu, contactez le service technique ou votre distributeur.	



Estenda o painel frontal até à sua posição de abertura máxima, para otimizar a capacidade de extracção.

O conmutador, de três posições, tem as seguintes funções:

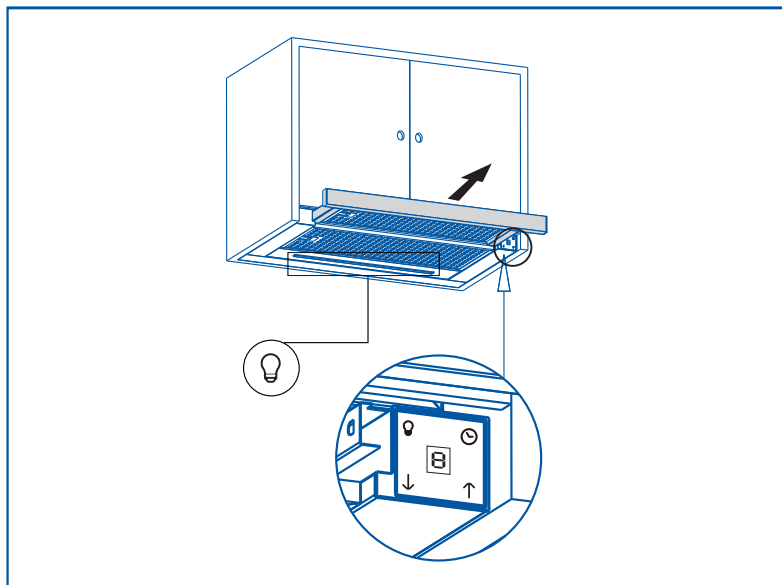

Four-button panel

To obtain the best results from your cooker hood it is recommended that you leave it switched on for up to 15 minutes after you have finished cooking.

	Light On/Off
	Fan On/Off and Speed Reduction
	LED Display
	Boost Function and Speed Increase
	Timer

To Set Up For First Use

Ducted Option \square This is the factory default setting if you are extracting air to the outside.

Recirculation Option \equiv This is the option to be used with carbon filters.

To change to this option, press both Speed icons $\downarrow \uparrow$ together and the Timer \odot will flash red.

Press the Speed Increase \uparrow to change to the Recirculation Option \equiv and the Speed Reduction \downarrow to revert back to the Ducted Option \square . Finally, press both Speed icons $\downarrow \uparrow$ together one more time to confirm the change and the Timer \odot will stop flashing.



NOTE: This operation must be undertaken within two minutes of switching the power on at the mains outlet. To change this setting at a later time, switch off the power at the mains outlet, wait a few seconds, turn on the power and repeat the above.

General Use

Light On/Off

- Use this control to switch the light on independently of the fan motor, it will be lit red in this mode.
- When the fan is in use, and the light is off, the icon will be lit white in this mode, but will turn red if the light is then switched on.

Fan On/Off and Speed Reduction

- Press this icon once to turn on the fan motor at speed 1. All icons will be lit white and the light icon will be red if already in use.
- If the motor is on speed 1, pressing and holding this icon for two seconds will turn off the fan motor. As above, the light control is independent of this operation.
- If the motor is higher than speed 1, this will reduce the fan speed with each press of the icon.

LED Display

- Shows the extraction mode during set up \square or \equiv and the motor speeds from 1-5, and P for





Boost. Boost Function and Speed Increase

- Press this icon once to turn on the fan motor at full power, and P will flash in the display,
- If the motor is already on speed 1-5, each press of this icon will increase the fan speed accordingly.
- If you press and hold the icon for two seconds, the fan speed will increase to full power and P will flash in the display.



NOTE: Full power or Boost only operates for five minutes maximum to conserve energy and the fan speed will automatically drop to speed level 3 after this time.

Timer

- When the fan motor is on and the Timer  icon is pressed, the icon will be lit red and the current speed in the display will start to flash.
- The chosen speed level will remain in use for five minutes before dropping down to the next lowest speed. This speed will remain in operation for two minutes before dropping down again. This will be repeated every two minutes unless the speed is already at level 1 and then the fan will turn off. If the light is already on, this will also be turned off.
- Pressing the Speed Reduction  or Speed Increase  icon during a current timer program will restart the countdown process again with a five minute cycle.
- If the Timer  icon is pressed again during a current timer program, the cycle will be cancelled, the icon will revert to white and the current fan speed will remain on indefinitely.
- The maximum timer program cycle is 15 minutes: 5 minutes on P and then 2 minutes each on speed 3 down to speed 1.



MANUTENÇÃO DO EXAUSTOR



Atenção: desligue sempre a corrente eléctrica antes de realizar a manutenção do exaustor. Em caso de avaria, contacte um distribuidor oficial ou um agente autorizado.

Limpeza exterior: utilize detergente líquido, não corrosivo e evite utilizar produtos de limpeza abrasivos e dissolventes.

Não utilize dispositivos de limpeza de alta pressão ou a vapor.



Importante: aumente a frequência de limpeza/substituição dos filtros se utiliza o exaustor mais do que 2 horas por dia. Utilize sempre os filtros originais do fabricante.

Filtros de gordura

para evitar possíveis incêndios, limpe-os rigorosamente uma vez por mês ou quando a luz de aviso indicar. Para isso, desmonte os filtros e lave-os com água quente e detergente.

Se utilizar a máquina de lavar loiça (pode escurecer as partes metálicas sem afetar a sua capacidade funcional), coloque verticalmente os filtros para evitar a acumulação de resíduos sólidos.

1 MÊS

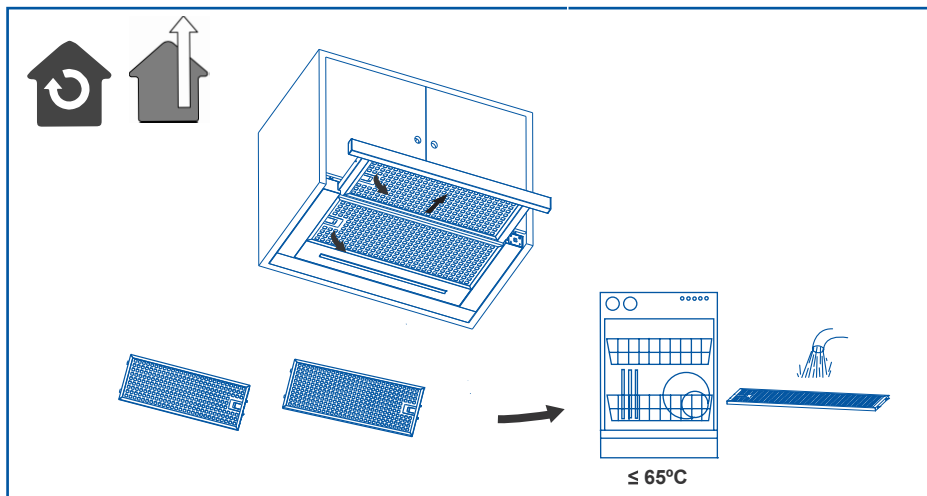



Problema	Causa possível	Solução
Vibração excessiva.	O aparelho não está devidamente instalado nos suportes.	Retire o aparelho e verifique se está corretamente fixado.
	A pá do ventilador está danificada.	Desligue o aparelho. Reparação a ser efetuada apenas por pessoal de manutenção qualificado.
	O motor do ventilador não está bem fixo.	
A luz está acesa, mas o ventilador não funciona.	A pá do ventilador está bloqueada.	Desligue o aparelho. Reparação a ser efetuada apenas por pessoal de manutenção qualificado.
	O motor está danificado.	
Tanto as luzes como o motor não funcionam.	Lâmpada fundida.	Entre em contacto com o serviço de atendimento ao cliente .
	Ligação de alimentação solta.	Verifique a fonte de alimentação.
Redução do desempenho de sucção.	A velocidade pode ser muito baixa.	Selecione uma velocidade superior.
	Os filtros de alumínio estão sujos.	Limpe os filtros de alumínio. (Consulte a secção Cuidados e manutenção).
	O respiro superior pode estar obstruído.	Elimine qualquer obstrução.
	O kit de ventilação opcional pode estar torcido.	Certifique-se de que o kit de ventilação está montado de acordo com as instruções do fabricante.
	A instalação pode não estar em conformidade com as instruções dos fabricantes.	A mangueira do respiro deve ter um diâmetro correto em todo o comprimento, sem reduções ou restrições. (Consulte a secção de instalação).
Funciona normalmente mas os odores resultantes de cozinhar permanecem.	O filtro de carbono não está instalado no modo de recirculação ou está cheio de gordura.	Instale o filtro de carbono ou substitua o filtro de carvão (Consulte a secção Cuidados e manutenção).
O exaustor não funciona	Verifique se o exaustor está conectado à energia. Verifique se os fusíveis ou automático não saltaram.	
O exaustor ainda não funciona	Se, depois de ter verificado os pontos mencionados acima, o seu problema ainda não tiver sido resolvido, entre em contato com o serviço técnico ou com o seu distribuidor.	



VERWENDUNG





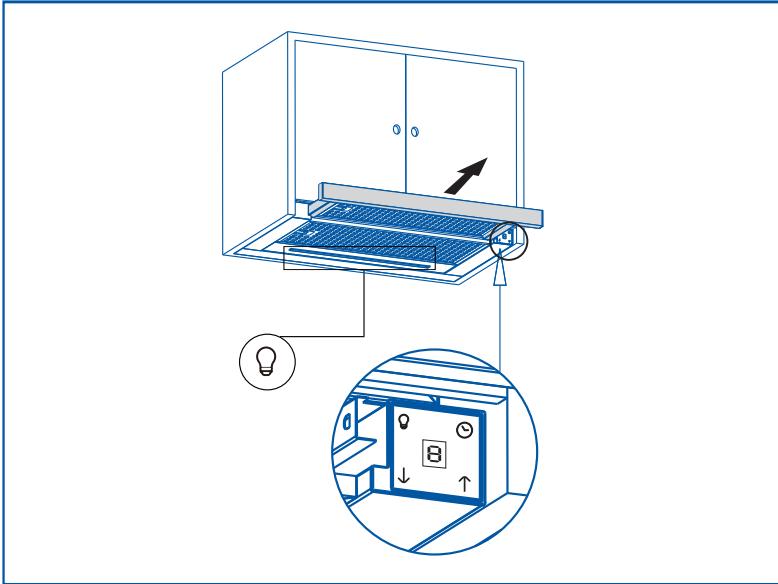





Die Frontplatte muss gezogen werden, um eine maximale Ausdehnung zu erreichen, so dass die Absaugleistung optimiert wird.

Der Dreistellungsschalter hat die folgenden Funktionen:





Four-button panel

To obtain the best results from your cooker hood it is recommended that you leave it switched on for up to 15 minutes after you have finished cooking.







	    
	Light On/Off
	Fan On/Off and Speed Reduction
	LED Display
	Boost Function and Speed Increase
	Timer

To Set Up For First Use

Ducted Option  This is the factory default setting if you are extracting air to the outside.

Recirculation Option  This is the option to be used with carbon filters.

To change to this option, press both Speed icons   together and the Timer  will flash red.

Press the Speed Increase  to change to the Recirculation Option  and the Speed Reduction  to revert back to the Ducted Option . Finally, press both Speed icons   together one more time to confirm the change and the Timer  will stop flashing.



NOTE: This operation must be undertaken within two minutes of switching the power on at the mains outlet. To change this setting at a later time, switch off the power at the mains outlet, wait a few seconds, turn on the power and repeat the above.

General Use



Light On/Off

- Use this control to switch the light on independently of the fan motor, it will be lit red in this mode.
- When the fan is in use, and the light is off, the icon will be lit white in this mode, but will turn red if the light is then switched on.

Fan On/Off and Speed Reduction

- Press this icon once to turn on the fan motor at speed 1. All icons will be lit white and the light icon will be red if already in use.
- If the motor is on speed 1, pressing and holding this icon for two seconds will turn off the fan motor. As above, the light control is independent of this operation.
- If the motor is higher than speed 1, this will reduce the fan speed with each press of the icon.

LED Display





- Shows the extraction mode during set up  or  and the motor speeds from 1-5, and P for Boost. **Boost Function and Speed Increase**

- Press this icon once to turn on the fan motor at full power, and P will flash in the display,
- If the motor is already on speed 1-5, each press of this icon will increase the fan speed accordingly.
- If you press and hold the icon for two seconds, the fan speed will increase to full power and P will flash in the display.



NOTE: Full power or Boost only operates for five minutes maximum to conserve energy and the fan speed will automatically drop to speed level 3 after this time.

Timer

- When the fan motor is on and the Timer  icon is pressed, the icon will be lit red and the current speed in the display will start to flash.
- The chosen speed level will remain in use for five minutes before dropping down to the next lowest speed. This speed will remain in operation for two minutes before dropping down again. This will be repeated every two minutes unless the speed is already at level 1 and then the fan will turn off. If the light is already on, this will also be turned off.
- Pressing the Speed Reduction  or Speed Increase  icon during a current timer program will restart the countdown process again with a five minute cycle.
- If the Timer  icon is pressed again during a current timer program, the cycle will be cancelled, the icon will revert to white and the current fan speed will remain on indefinitely.
- The maximum timer program cycle is 15 minutes: 5 minutes on P and then 2 minutes each on speed 3 down to speed 1.



PFLEGE UND WARTUNG



Warnung: Schalten Sie vor Wartungsarbeiten an der Kapuze. Wenden Sie sich im Falle einer Störung an einen Vertragshändler oder eine Vertragsfirma.

Reinigung der Außenseite: Verwenden Sie ein flüssiges, nicht korrosives Reinigungsmittel und vermeiden Sie die Verwendung von Scheuermitteln. Verwenden Sie keine Hochdruck- oder Dampfreinigungsgeräte.



Wichtig: Erhöhen Sie die Häufigkeit der Filterreinigung/des Filterwechsels, wenn die Haube für mehr als 2 Stunden am Tag. Verwenden Sie immer Originalfilter des Herstellers.

Reinigung mit Fett

Um Brände zu vermeiden, reinigen Sie einmal im Monat oder immer dann, wenn die Kontrollleuchte des Displays solche. Entfernen Sie dazu die Filter und waschen Sie sie mit heißem Wasser und Reinigungsmittel. Bei Verwendung einer Spülmaschine (Metallteile können sich schwarz verfärben, ohne dass dies ihre Funktionsfähigkeit beeinträchtigt), die Filter belasten vertikal, um die Ablagerung von festen Rückständen zu vermeiden.

1 MONAT

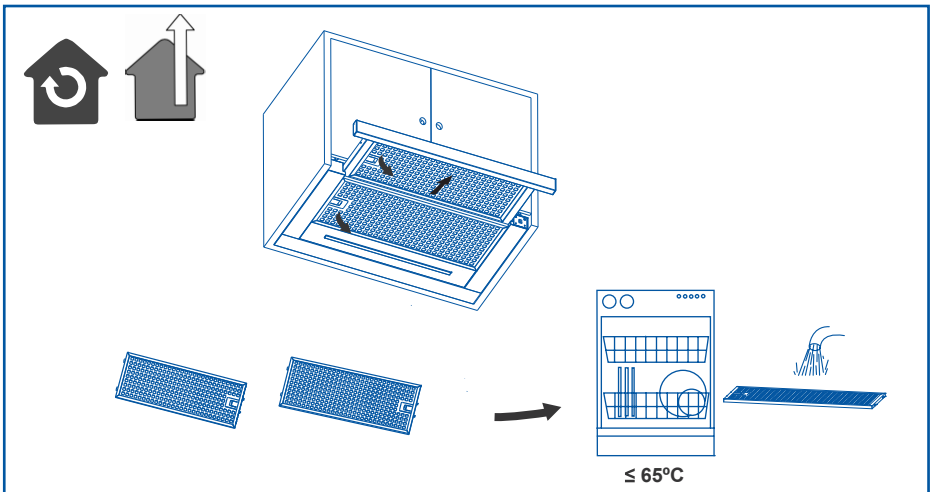



Problem	Mögliche Ursache	Lösung
Übermäßige Vibration.	Das Gerät ist nicht ordnungsgemäß an den Halterungen montiert.	Nehmen Sie das Gerät ab und prüfen Sie, ob es korrekt befestigt ist.
	Das Lüfterblatt ist beschädigt.	Wenden Sie sich bitte an Ihren Händler.
	Der Lüftermotor wurde nicht fest genug montiert.	
Die Lampe ist eingeschaltet, aber der Lüfter funktioniert nicht.	Das Lüfterblatt klemmt.	
	Der Motor ist beschädigt.	
Licht und Motor funktionieren nicht.	Die Glühlampe ist durchgebrannt.	Wenden Sie sich bitte an Ihren Händler.
	Der Stromanschluss ist locker.	Überprüfen Sie die Stromversorgung.
Absaugleistung reduziert.	Geschwindigkeit möglicherweise zu gering.	Wählen Sie eine höhere Geschwindigkeit.
	Aluminiumfilter sind verschmutzt.	Reinigen Sie die Aluminiumfilter. (Siehe Abschnitt "Pflege und Wartung").
	Oberer Luftabzug möglicherweise verstopft.	Entfernen Sie Verstopfungen.
	Optionaler Entlüftungsbausatz möglicherweise verdreht.	Stellen Sie sicher, dass Sie den Entlüftungsbausatz gemäß den Anweisungen des Herstellers montiert haben.
	Die Installation wurde möglicherweise nicht gemäß den Anweisungen des Herstellers ausgeführt.	Der Luftabzugsschlauch muss über den gesamten Verlauf den korrekten Durchmesser ohne Einschränkung oder Reduktion haben. (siehe Abschnitt "Installation").
Funktioniert normal, aber Kochgerüche ziehen nicht ab.	Im Umlaufmechanismus wurde kein Kohlefilter angebracht, oder dieser ist durch Fett verstopft.	Bringen Sie einen Kohlefilter an oder ersetzen Sie den alten Kohlefilter (siehe Abschnitt "Pflege und Wartung").
Die Haube funktioniert nicht	Prüfen Sie, ob die Haube an die Stromversorgung angeschlossen ist. Prüfen Sie, dass die Sicherungen oder die Automatik nicht gesprungen sind.	
Die Haube funktioniert immer noch nicht	Sollte Ihr Problem nach der Überprüfung der oben genannten Punkte noch nicht gelöst sein, wenden Sie sich an den technischen Service oder Ihren Händler.	



CNA
group

CATA ELECTRODOMÉSTICOS, S.L.

Oficinas: c/ Anabel Segura, 11, Edif. A, 3a pl. 28108. Alcobendas. Madrid. España

Fábrica: c/ del Ter 2, Apdo. 9. 08570. Torelló. Barcelona. España

T. +34 938 594 100 - Fax +34 938 594 101

www.cnagroup.es - cna@cnagroup.es

Atención al Cliente: 902 410 450 / +34 938 521 818 - info@cnagroup.es

SAT Central Portugal: +351 214 349 771 - service@junis.pt