

ONEXUS



Charging Time Setting
Freely set the charging time and duration

Charging History Record
Query charging history anytime, anywhere

Remote Control by APP
Start or stop charging via Wifi or Bluetooth

Firmware Update
Make app version upgrades

APP version

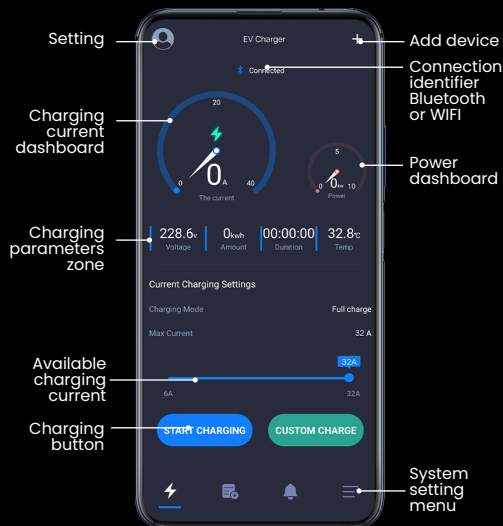

HISTORY RECORD

Check your charging history documents anytime



OXI MODEL C

Input & Output

Input voltage/Output voltage	AC 230V/400V
Input frequency	47~63Hz
Max. output power	7.6KW(1 Phase)/22KW(3 Phase)
Max. output current	32A
Charging interface type	IEC 62196-2, SAE J1772

PROTECTION

Over voltage protection	✓
Under voltage protection	✓
Over load protection	✓
Short circuit protection	✓
Earth leakage protection	✓
Over-temp protection	✓
Lightning protection	✓

FUNCTION

WiFi/Bluetooth	✓
LCD	3.5-inch color display
RCD	Type A / Type A+6mA DC
LED Indicator light	✓
Intelligent power adjustment	✓
RFID	Optional

WORKING ENVIRONMENT

Protection degree	IP66
Environment temperature	°C+75 -40°C
Relative humidity	0-95% non-condensing
Maximum altitude	<2000m
Cooling	Natural air cooling
Standby power consumpition	<8W

MECHNICAL

Dimension (W/H/D)	295/195/65mm
Weight	6KG-8KG

MOUNTING ACCESSORIES

Wall-mounting bracket	✓
Ground-mounting pole	Optional

CERTIFICATE

Certificate	CE, FCC, CSA, RoHS
-------------	--------------------